



NORDLAND
EQUIPMENT
Nordland by Fieldking

Landscape Rake



➤ [Operator Manual](#) ➤ [Service Manual](#) ➤ [Parts Catalog](#)

CONGRATULATIONS!

You have invested in one of the best implements of its type in the market today.

The care you give your NORDLAND implement will greatly determine your satisfaction with its performance and its service life. A careful study of this manual will give you a thorough understanding of your new implement before operating.

If your manual is lost or destroyed, NORDLAND will be glad to provide you a new copy. Please visit the nearest NORDLAND Dealership to get a new copy. Most of our manuals can also be downloaded from our website at www.edneyco.com.

As an authorized NORDLAND dealer, we stock genuine NORDLAND parts which are manufactured with the same precision and skill as our original equipment. Our service technicians are well trained on methods required to service NORDLAND equipment and are ready to help you.

Should you require additional information or assistance, please contact us.

YOUR AUTHORIZED

NORDLAND DEALER

BECAUSE NORDLAND MAINTAINS AN ONGOING PRODUCT IMPROVEMENT PROGRAM. WE RESERVE THE RIGHT TO MAKE IMPROVEMENTS IN DESIGN OR CHANGE IN SPECIFICATION WITHOUT INCURRING ANY OBLIGATION TO INSTALL THEM ON UNITS PREVIOUSLY SOLD. BECAUSE OF THE POSSIBILITY THAT SOME PHOTOGRAPHS IN THIS MANUAL WERE TAKEN OF PROTOTYPE MODELS, PRODUCTION MODELS MAY VARY IN SOME DETAIL. IN ADDITION, SOME PHOTOGRAPHS MAY SHOW SHIELDS REMOVED FOR THE PURPOSE OF CLARITY. NEVER OPERATE THIS IMPLEMENT WITHOUT ALL SHIELDS IN PLACE.

TO THE PURCHASER

This manual contains valuable information about your new NORDLAND Landscape Rake. It has been carefully prepared to give you helpful suggestions for operating, adjusting, servicing and ordering spare parts.

Keep this manual in a convenient place for quick and easy reference. Study it carefully. You have purchased a dependable and sturdy Landscape Rake, but only by proper care.

Sometime in the future your Landscape Rake may need new parts to replace which are worn out or broken. If so, go to your dealer with model no of the machine and part number(s) to order replacements.

CUSTOMER INFORMATION

Name _____

Purchased From _____

Date of Purchase _____

Model No. _____

Serial No. _____

PURCHASER / OPERATOR'S RESPONSIBILITY

1. Read and understand the information contained in this manual.
2. Operate, lubricate, assemble and maintain the equipment in accordance with all instructions and safety procedures in this manual.
3. Inspect the equipment and replace or repair any parts that are damaged or worn out which under continued operation would cause damage, wear to other parts, or cause a safety hazard.
4. Return the equipment or parts to the authorized NORDLAND dealer, from where it was purchased, for service or replacement of defective parts that are covered by warranty. (The NORDLAND Factory may inspect equipment or parts before warranty claims are honored.)
5. All costs incurred by the dealer for traveling to or transporting the equipment for warranty inspection and claims will be borne by the customer.

INDEX

- 1. General Information**
- 2. Safety Rules**
 - 2.1 Training
 - 2.2 Preparation
 - 2.3 Operation
 - 2.4 Maintenance
 - 2.5 Storage
- 3. Safety And Instructional Decals**
- 4. Operation**
 - 4.1 Connect Implement To The Tractor
 - 4.2 Operating Techniques
- 5. Maintenance**
 - 5.1 Replacing Rake Tines
- 6. Assembly Instructions**
- 7. Dealer Check Lists**
 - 7.1 Pre Delivery Check List
 - 7.2 Delivery Check List
- 8. Parts Manual**
- 9. Bolt Torque Chart**

1. GENERAL INFORMATION

The purpose of this manual is to assist you in operating and maintaining your equipment. Read it carefully. It furnishes information and instructions that will help you achieve years of dependable performance. These instructions have been compiled from extensive field experience and engineering data. Some information may be general in nature, due to unknown and varying operating conditions. However, through experience and these instructions, you should be able to develop procedures suitable to your particular situation.

The Landscape Rake is a tractor mounted implement which is basically used for loosening, levelling, clearing soil of debris. It can be operated in both forward and reverse direction.

The illustrations and data used in this manual were current at the time of printing. However, due to possible inline production changes, your machine may vary slightly in detail. We reserve the right to redesign and change the machines as may be necessary without notification. Throughout this manual, references are made to right and left directions. These are determined by standing behind the tractor facing the direction of forward travel.

2. SAFETY RULES

Safety is a primary concern in the design and manufacture of our products. Unfortunately, our efforts to provide safe equipment can be wiped out by an operator's single careless act. In addition to the design and configuration of equipment, hazard control and accident prevention are dependent upon the awareness, concern, judgement, and proper training of personnel involved in the operation, transport, maintenance and storage of equipment. It has been said "The best safety device is an informed, careful operator." We ask you to be that kind of operator.

2.1 TRAINING

Safety instructions are important! Read all attachment and power unit manuals; follow all safety rules and safety decal information. (Replacement manuals and safety decals are available from your dealer.

- If you do not understand any part of this manual and need assistance, see your dealer.
 - Know your controls and how to shut down quickly in an emergency.
 - Operators must be instructed in and be capable of the safe operation of the equipment, its attachments, and all controls. Do not allow anyone to operate this equipment without proper instructions.
- Never allow children or untrained persons to operate equipment.

2.2 PREPARATION

- Check that all hardware is properly installed. Always tighten to torque chart specifications unless instructed otherwise in this manual.
- Always wear relatively tight and belted clothing to avoid entanglement in moving parts. Wear sturdy, rough-soled work shoes and protective equipment for eyes, hair, hands, hearing, and head; and respirator or filter mask where appropriate.
- Make sure attachment is properly secured, adjusted, and in good operating condition.
- Power unit must be equipped with ROPS or ROPS cab and seat belt. Keep seat belt securely fastened. Falling off power unit can result in death from being run over or crushed. Keep foldable ROPS systems in "locked up" position at all times.
- Make sure all safety decals are installed. Replace if damaged.
- A minimum 20% of tractor and equipment weight must be on the tractor front wheels when attachments are in transport position. Without this weight, front tractor wheels could raise up resulting in loss of steering. The weight may be attained with front wheel weights, ballast in tires, front tractor weights or front loader. Weigh the tractor and equipment. Do not estimate.

2.3 OPERATION

- Consult local utilities before working. Know location of all underground cables, pipelines, overhead wires, and other hazards in working area and avoid contact. Many states have laws compelling a locate request prior to digging. Check local statutes to be sure you are in compliance.
- Keep bystanders away from equipment.
- Do not operate or transport equipment while under the influence of alcohol or drugs.
- Operate only in daylight or good artificial light.
- Keep hands, feet, hair, and clothing away from equipment while engine is running. Stay clear of all moving parts.
- Always comply with all state and local lighting and marking requirements.
- Never allow riders on power unit or attachment.
- Power unit must be equipped with ROPS or ROPS cab and seat belt. Keep seat belt securely fastened. Falling off power unit can result in death from being run over or crushed. Keep foldable ROPS systems in "Locked up" position at all times.
- Always sit in power unit seat when operating controls or starting engine. Securely fasten seat belt, place transmission in neutral, engage brake, and ensure all other controls are disengaged before starting power unit engine.

- Look down and to the rear and make sure area is clear before operating in reverse.
- Do not operate or transport on steep slopes.
- Do not stop, start, or change directions suddenly on slopes.
- Use extreme care and reduce ground speed on slopes and rough terrain.
- Watch for hidden hazards on the terrain during operation.
- Stop power unit and equipment immediately upon striking an obstruction. Turn off engine, remove key, inspect, and repair any damage before resuming operation.
- Before changing positions of manual swing, tilt, or angle positions:
 - a. Park tractor on level ground, apply parking brake, level implement boom, shut off tractor, and remove key.
 - b. Make manual changes slowly and carefully to prevent hazardous movement of mechanisms.
 - c. Never stand in positions where you could become entrapped during adjustment changes or if the 3-point hitch suddenly lowers.
- Always secure lock pins with safety pins to prevent lock pins from bumping out of the positioning holes. Failure to do so may result in accidents and/ or damage to rake tine.
- Before dismounting power unit or performing any service or maintenance, follow these steps: disengage power to equipment, lower the 3-point hitch and all raised components to the ground, operate valve levers to release any hydraulic pressure, set parking brake, stop engine, remove key, and unfasten seat belt.
- **NEVER GO UNDERNEATH EQUIPMENT.** Never place any part of the body underneath equipment or between moveable parts even when the engine has been turned off. Hydraulic system leak down, hydraulic system failures, mechanical failures, or movement of control levers can cause equipment to drop or rotate unexpectedly and cause severe injury or death.
 - a. Service work does not require going underneath.
 - b. Read Operator's Manual for service instructions or have service performed by a qualified dealer.

2.4 MAINTENANCE

- Before dismounting power unit or performing any service or maintenance, follow these steps: disengage power to equipment, lower the 3-point hitch and all raised components to the ground, operate valve levers to release any hydraulic pressure, set parking brake, stop engine, remove key, and unfasten seat belt.

- **NEVER GO UNDERNEATH EQUIPMENT.** Never place any part of the body underneath equipment or between moveable parts even when the engine has been turned off. Hydraulic system leak down, hydraulic system failures, mechanical failures, or movement of control levers can cause equipment to drop or rotate unexpectedly and cause severe injury or death.
 - a. Service work does not require going underneath.
 - b. Read Operator's Manual for service instructions or have service performed by a qualified dealer.
- Always wear relatively tight and belted clothing to avoid entanglement in moving parts. Wear sturdy, rough-soled work shoes and protective equipment for eyes, hair, hands, hearing, and head and respirator or filter mask where appropriate.
- Make sure attachment is properly secured, adjusted, and in good operating condition.
- Keep all persons away from operator control area while performing adjustments, service, or maintenance.
- Tighten all bolts, nuts and screws to torque chart specifications. Check that all cotter pins are installed securely to ensure equipment is in a safe condition before putting unit into service.
- Make sure all safety decals are installed. Replace if damaged. (See Safety Decals section for location.)

2.5 STORAGE

- Block equipment securely for storage.
- Keep children and bystanders away from storage area.
- Follow manual instructions for storage.

⚠ 3. SAFETY & INSTRUCTIONAL DECALS

ATTENTION! BECOME ALERT! YOUR SAFETY IS INVOLVED!



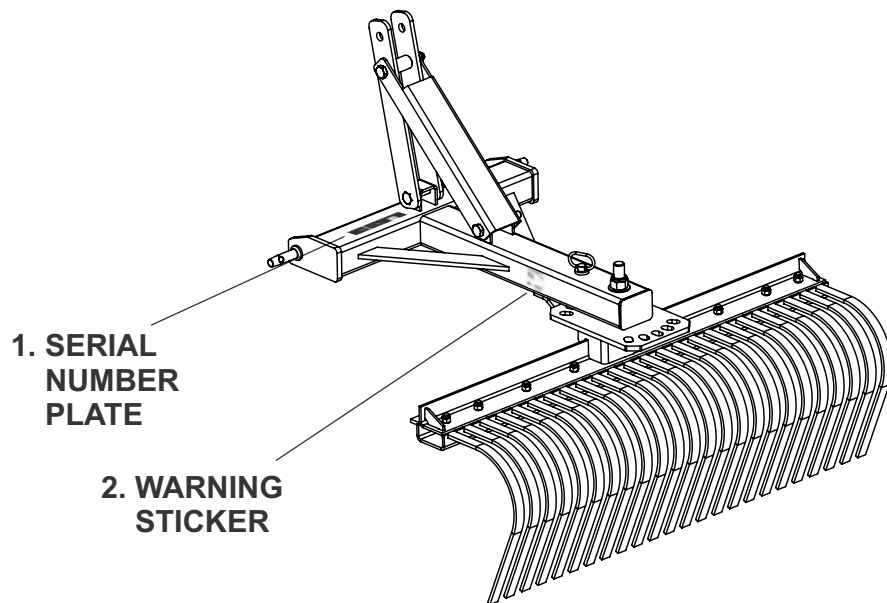

Nordland Serial Number Plate Design (197x45mm)

1



2

Use a clean, damp cloth to clean safety decals. Avoid spraying too close to decals when using a pressure washer; high-pressure water can enter through very small scratches or under edges of decals causing them to peel or come off.

4. OPERATION

The operator is responsible for the safe operation of this equipment. Operators must be instructed in and be capable of the safe operation of the equipment, its attachments and all controls. Do not allow anyone to operate this equipment without proper instructions.

This equipment is designed for a wide range of applications. The Rake may be used for loosening, levelling and clearing soil of debris. It may be angled to windrow debris to the side for removal.

⚠ WARNING

- Never allow children or untrained persons to operate equipment.
- Keep bystanders away from equipment.
- Never allow riders on power unit or attachment.
- A minimum 20% of tractor and equipment weight must be on the tractor front wheels when attachments are in transport position. Without this weight, tractor could tip over, causing personal injury or death. The weight may be attained with a loader, front wheel weights, ballast in tires or front tractor weights. Weigh the tractor and equipment. Do not estimate.

⚠ CAUTION

Always wear relatively tight and belted clothing to avoid entanglement in moving parts. Wear sturdy, rough-soled work shoes and protective equipment for eyes, hair, hands, hearing, and head; and respirator or filter mask where appropriate.

4.1 CONNECT IMPLEMENT TO TRACTOR

- The Implement should be mounted on tractors with a maximum draw bar rating of 30 engine hp, not to exceed 2400 lbs.
- Adjust or remove tractor draw bar to eliminate interference with rake.

Category 1

- Place tractor 3-point lower lift arms over outer hitch pins.
- Secure with Linch pin (not provided) as shown in Figure.
- Connect tractor top link by inserting tractor clevis pin into top hitch point on tine frame assembly and secure.



4.2 OPERATING TECHNIQUES

Level the A-frame and boom with 3-point connecting links and top link. Adjusting the top link length will change the fore and aft pitch of the tool. Lengthening the top link will cause the tool to contact the ground with a sharper pitch and feed itself into the ground more readily.

When using the rake tool, you may need to adjust the tail wheels after adjusting pitch to maintain the desired working depth. Position 3-point lift arm sway blocks or tighten sway chains to eliminate side sway. Install side braces if necessary.

4.2.1. Reversing

For most tractors, the rake may be rotated 360 degrees without unhooking from the tractor. To rotate without unhooking, pull hitch pin assembly. Rotate to desired position; replace hitch pin assembly.

4.2.2. Angling

Remove hitch pin assembly. The rake may be set 17 degrees or 34 degrees to the left or right for forward grading.

4.2.3. Back-filling

Remove hitch pin assembly. Reverse the rake assembly in backward direction for light back-filling ditches or trenches.

PRE-OPERATION CHECK LIST (Owner's Responsibility Before Each Use)

- Review and follow all safety rules and safety decal instructions..
- Check that all safety decals are installed and in good condition. Replace if damaged.
- Check that all hardware is properly installed and secured.
- Check that equipment is properly and securely attached to tractor.
- Do not allow riders.
- Make sure tractor ROPS or ROPS cab and seat belt are in good condition. Keep seat belt securely fastened during operation.
- Consult local utilities before digging. Know location of and avoid contacting all underground cables, pipelines, overhead wires and other hazards in digging area. Many states have laws compelling a locate request prior to digging. Check local statutes to be sure you are in compliance.

5. MAINTENANCE

- The information in this section is written for operators who possess basic mechanical skills. If you need help, your dealer has trained service technicians available. For your protection, read and follow all safety information in this manual.
- Before dismounting power unit or performing any service or maintenance, follow these steps: disengage power to equipment, lower the 3-point hitch and all raised components to the ground, operate valve levers to release

any hydraulic pressure, set parking brake, stop engine, remove key, and unfasten seat belt.

- **NEVER GO UNDERNEATH EQUIPMENT.** Never place any part of the body underneath equipment or between moveable parts even when the engine has been turned off. Hydraulic system leak down, hydraulic system failures, mechanical failures, or movement of control levers can cause equipment to drop or rotate unexpectedly and cause severe injury or death.

WARNING

- Service work does not require going underneath.
- Read Operator's Manual for service instructions or have service performed by a qualified dealer.
- Keep all persons away from operator control area while performing adjustments, service, or maintenance.

CAUTION

- Always wear relatively tight and belted clothing to avoid entanglement in moving parts. Wear sturdy, rough-soled work shoes and protective equipment for eyes, hair, hands, hearing, and head; and respirator or filter mask where appropriate.

5.1 REPLACING RAKE TINES

Remove Rake Tines

- Remove carriage bolt (3), and hex lock nuts (4), Loosen the rake bracket (5), Remove Rake Tine (2) from Tine assembly (1) and replace with new Rake Tine. Re-install hardware previously removed.

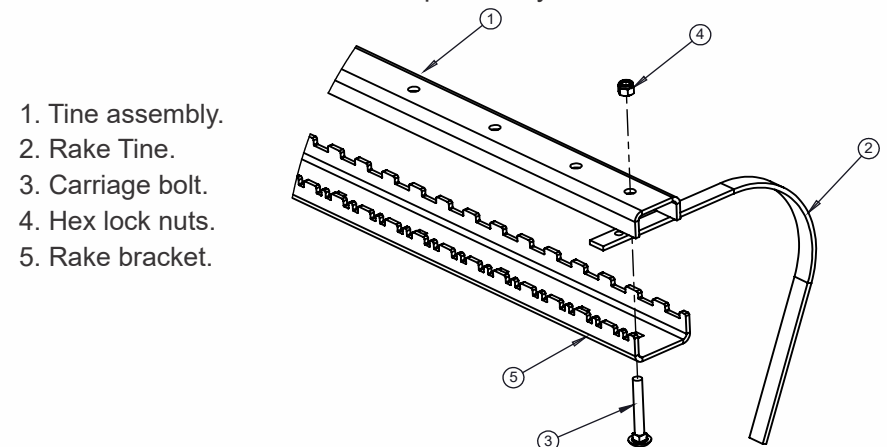

6. ASSEMBLY INSTRUCTIONS

Assembly of this Landscape Rake is the responsibility of the dealer. It should be delivered to the owner completely assembled, lubricated and adjusted for normal cutting conditions.

The Landscape Rake is shipped partially assembled. Assembly will be easier if components are aligned and loosely assembled before tightening hardware.

- Before dismounting power unit or performing any service or maintenance, follow these steps: disengage power to equipment, lower the 3-point hitch and all raised components to the ground, operate valve levers to release any hydraulic pressure, set parking brake, stop engine, remove key, and unfasten seat belt.
- **NEVER GO UNDERNEATH EQUIPMENT.** Never place any part of the body underneath equipment or between moveable parts even when the engine has been turned off. Hydraulic system leak down, hydraulic system failures, mechanical failures, or movement of control levers can cause equipment to drop or rotate unexpectedly and cause severe injury or death.
 - a. Service work does not require going underneath.
 - b. Read Operator's Manual for service instructions or have service performed by a qualified dealer.
 - c. Keep all persons away from operator control area while performing adjustments, service, or maintenance.
- Always wear relatively tight and belted clothing to avoid entanglement in moving parts. Wear sturdy, rough-soled work shoes and protective equipment for eyes, hair, hands, hearing, and head; and respirator or filter mask where appropriate.

Assembly instruction of the Landscape Rake standard duty is given below:

1. Assemble Mount Frame assembly (1) onto threaded stud on Rake Tine mounting assembly (2) and secure with flat washer (8) and nylock nut (7).
2. Assemble TPL lever rear plate (13) on Mount Frame assembly (1) with M16x2Px125L Hex head bolt (10) and M16x2P nylock nut (6).
3. Assemble top holes of TPL lever support flat (12) with middle hole of TPL Lever flat (13) with M16x2Px105L Hex head bolt (5) along with TPL Lever bush (11) in the middle and tighten the nylock nut M16x2P (6) on the Hex Head bolt with spring washer 16mm (9).

4. Install hitch pin (4) thru hole in frame assembly and install the pin (3) into desired hole in pivot plate of Rake Tine mounting assembly (2).

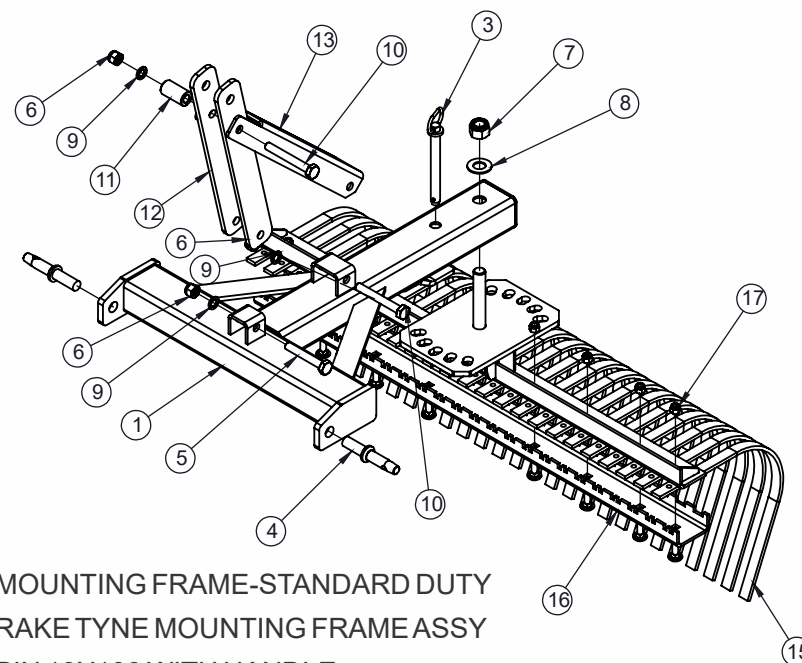

- 1 MOUNTING FRAME-STANDARD DUTY
- 2 RAKE TYNE MOUNTING FRAME ASSY
- 3 PIN 19X193 WITH HANDLE
- 4 HITCH PIN CAT-1
- 5 HEX HEAD BOLT M16X2PX105L
- 6 NYLOCK NUT M16X2P
- 7 NYLOCK NUT M24X3P
- 8 PLAIN WASHER 25MM
- 9 SPRING WASHER 16MM
- 10 HEX HEAD BOLT M16X2PX125L
- 11 TPL LEVER BUSH
- 12 TPL FRONT PLATE-STANDARD DUTY
- 13 TPL REAR PLATE-STANDARD DUTY
- 14 CARRIAGE SQ. NECK BOLT 1/2"-13 TPI UNC X 2.5"(L)
- 15 LANDSCAPE RAKE TYNE
- 16 TYNE BRACKET
- 17 NYLOCK NUT 1/2"-13 TPI UNC

Assembly instruction of the Landscape Rake heavy duty is given below:

1. Assemble Mount Frame (1), onto threaded bolt on tine mounting frame assembly (2) and secure with flat washer (6) and nylock nut (5).
2. Install hitch pin (9) thru hole in frame assembly and install the pin (7) into desired hole in pivot plate of Rake Tine mounting assembly (2).

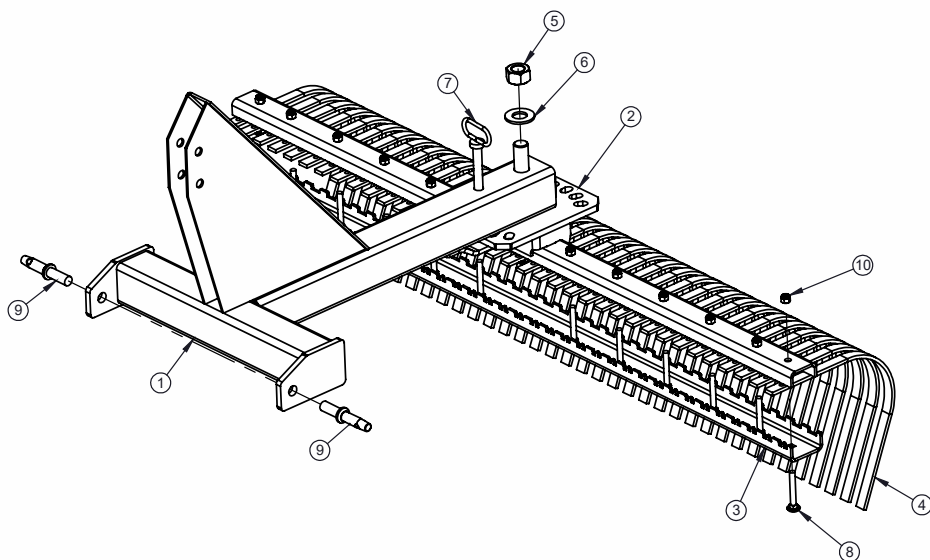

- 1 MOUNTING FRAME- HEAVY DUTY
- 2 RAKE TYNE MOUNTING FRAME ASSY
- 3 TYNE BRACKET
- 4 LANDSCAPE RAKE TYNE
- 5 NYLOCK NUT 1.25"-7 TPI UNC
- 6 PLAIN WASHER 32 MM
- 7 PIN 19X165 WITH HANDLE
- 8 CARRIAGE SQ. NECK BOLT 1/2"-13 TPI UNC X 3.5"(L)
- 9 HITCH PIN CAT-1
- 10 NYLOCK NUT 1/2"-13 TPI UNC

7. DEALER CHECK LISTS

7.1. PRE-DELIVERY CHECK LIST

Inspect the equipment thoroughly after assembly to ensure it is set up properly before delivering it to the customer.

The following check lists are a reminder of points to inspect. Check off each item as it is found satisfactory or after proper adjustment is made.

- Check that all safety decals are installed and in good condition. Replace if damaged.
- Properly attach implement to tractor and make all necessary adjustments.
- Check parking stand for proper operation.
- Check all bolts to be sure they are properly torqued.
- Check that all cotter pins and safety pins are properly installed. Replace if damaged.

7.2. DELIVERY CHECK LIST

- Show customer how to make adjustments.
- Instruct customer how to lubricate and explain importance of lubrication.
- Point out the safety decals. Explain their meaning and the need to keep them in place and in good condition. Emphasize the increased safety hazards when instructions are not followed.
- Present Operator's Manual and request that customer and all operators read it before operating equipment. Point out the manual safety rules, explain their meanings and emphasize the increased safety hazards that exist when safety rules are not followed.
- Explain to customer the potential crushing hazards of going underneath raised equipment.
- Instruct customer that service work does not require going underneath unit, never to do so.
- Show customer the safe, proper procedures to be used when mounting, dismounting, and storing equipment.
- For mounted units, add wheel weights, ballast in front tires, and/or front tractor weight to enhance front end stability. A minimum 20% of tractor and equipment gross weight must be on front tractor wheels. When adding weight to attain 20% of tractor and equipment weight on front tractor wheels, you must not exceed the ROPS weight certification. Weigh the tractor and equipment. Do not estimate.
- Make customer aware of optional equipment available so that customer can make proper choices as required.

Landscape Rake Standard Duty

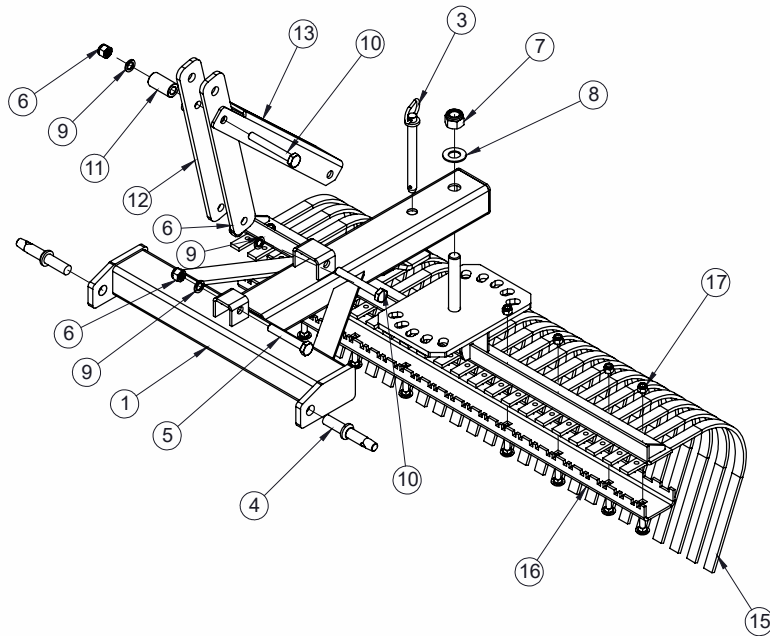

Sr. NO.	PART NAME	PART CODE			QTY.		
		4 FEET	5 FEET	6 FEET	4 FEET	5 FEET	6 FEET
1	MOUNTING FRAME-STANDARD DUTY	FKGB-5101			1		
2	RAKE TYNE MOUNTING FRAME ASSY	FKLR-5001	FKLR-5002	FKLR-5003	1		
3	PIN 19X193 WITH HANDLE	10020324			1		
4	HITCH PIN CAT-1	10020121			2		
5	HEX HEAD BOLT M16X2PX105L	10260134			1		
6	NYLOCK NUT M16X2P	10280025			3		
7	NYLOCK NUT M24X3P	10280075			1		
8	PLAIN WASHER 25MM	10270024			1		
9	SPRING WASHER 16MM	10270005			3		
10	HEX HEAD BOLT M16X2PX125L	10260367			2		
11	TPL LEVER BUSH	FKGB-112			1		
12	TPL FRONT PLATE-STANDARD DUTY	FKGB-110			2		
13	TPL REAR PLATE-STANDARD DUTY	FKGB-111			1		
14	CARRIAGE SQ. NECK BOLT 1/2"-13 TPI UNC X 2.5"(L)	10261062			8	10	12
15	LANDSCAPE RAKE TYNE	FKLR-001			24	30	36
16	TYNE BRACKET	FKLR-002	FKLR-003	FKLR-004	1		
17	NYLOCK NUT 1/2"-13 TPI UNC	10280347			8	10	12

Landscape Rake Heavy Duty

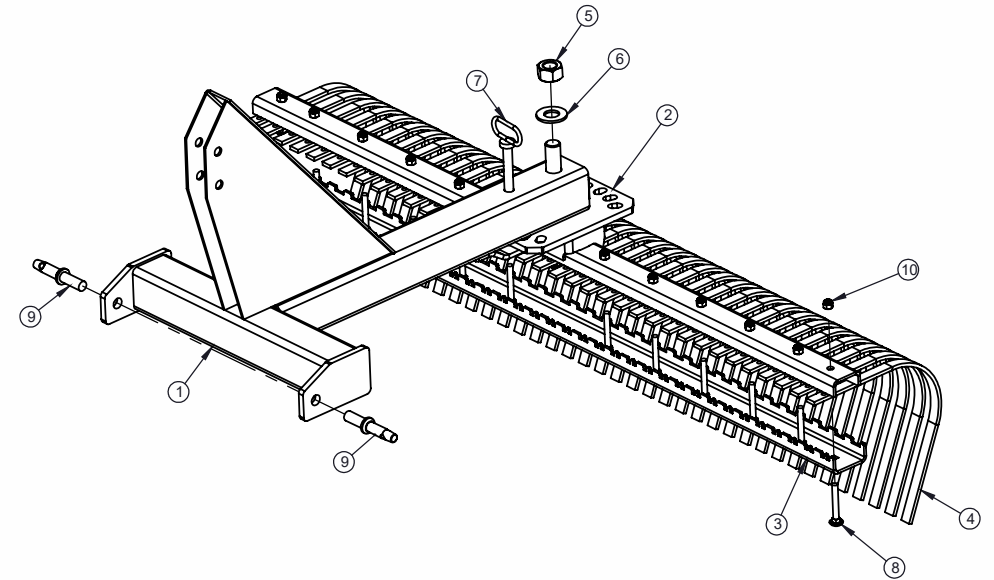

SR NO.	PART NAME	PART CODE			QTY.		
		6 FEET	7 FEET	8 FEET	6 FEET	7 FEET	8 FEET
1	MOUNTING FRAME- HEAVY DUTY	FKLR-5102			1		
2	RAKE TYNE MOUNTING FRAME ASSY	FKLR-5008	FKLR-5009	FKLR-5010	1		
3	TYNE BRACKET	FKLR-004	FKLR-005	FKLR-006	1		
4	LANDSCAPE RAKE TYNE	FKLR-001			36	42	48
5	NYLOCK NUT 1.25"-7 TPI UNC	10280348			1		
6	PLAIN WASHER 32 MM	10270023			1		
7	PIN 19X165 WITH HANDLE	10020324			1		
8	CARRIAGE SQ. NECK BOLT 1/2"-13 TPI UNC X 3.5"(L)	10261063			13	15	17
9	HITCH PIN CAT-1	10020121			2		
10	NYLOCK NUT 1/2"-13 TPI UNC	10280025			13	15	17

9. BOLT TORQUE CHART

- Always tighten hardware to these values unless a different torque value or tightening procedure is listed for a specific application.
- Fasteners must always be replaced with the same grade as specified in the manual parts list.
- Always use the proper tool for tightening hardware: SAE for SAE hardware and Metric for metric hardware.
- Make sure fastener threads are clean and you start thread engagement properly.
- All torque values are given to specifications used on hardware defined by SAE J1701 MAR 99 & J1701M JUL 96.

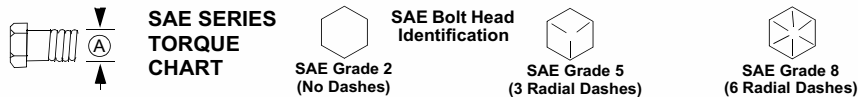

Diameter (Inches)	Wrench Size	MARKING ON HEAD					
		SAE 2		SAE 5		SAE 8	
		lbs-ft	N-m	lbs-ft	N-m	lbs-ft	N-m
1/4"	7/16"	6	8	10	13	14	18
5/16"	1/2"	12	17	19	26	27	37
3/8"	9/16"	23	31	35	47	49	67
7/16"	5/8"	36	48	55	75	78	106
1/2"	3/4"	55	75	85	115	120	163
9/16"	13/16"	78	106	121	164	171	232
5/8"	15/16"	110	149	170	230	240	325
3/4"	1-1/8"	192	261	297	403	420	569
7/8"	1-5/16"	306	416	474	642	669	907
1"	1-1/2"	467	634	722	979	1020	1383

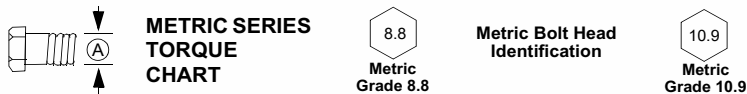

<div>Ⓐ</div> <div>Diameter & Thread Pitch (Millimeters)</div>	Wrench Size	Coarse Thread				Fine Thread				<div>Ⓐ</div> <div>Diameter & Thread Pitch (Millimeters)</div>
		Marking on Head				Marking on Head				
		Metric 8.8		Metric 10.9		Metric 8.8		Metric 10.9		
		N-m	lbs-ft	N-m	lbs-ft	N-m	lbs-ft	N-m	lbs-ft	
6 x 1.0	10 mm	8	6	11	8	8	6	11	8	6 x 1.0
8 x 1.25	13 mm	20	15	27	20	21	16	29	22	8 x 1.0
10 x 1.5	16 mm	39	29	54	40	41	30	57	42	10 x 1.25
12 x 1.75	18 mm	68	50	94	70	75	55	103	76	12 x 1.25
14 x 2.0	21 mm	109	80	151	111	118	87	163	120	14 x 1.5
16 x 2.0	24 mm	169	125	234	173	181	133	250	184	16 x 1.5
18 x 2.5	27 mm	234	172	323	239	263	194	363	268	18 x 1.5
20 x 2.5	30 mm	330	244	457	337	367	270	507	374	20 x 1.5
22 x 2.5	34 mm	451	332	623	460	495	365	684	505	22 x 1.5
24 x 3.0	36 mm	571	421	790	583	623	459	861	635	24 x 2.0
30 x 3.0	46 mm	1175	867	1626	1199	1258	928	1740	1283	30 x 2.0

Typical Washer Installations

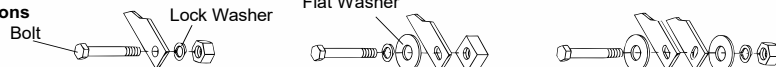

DELIVERY CHECKLIST

Dealer Pre-Delivery (Please Tick)	Please Complete all Dealer information Below
1. Dealer Pre-Delivery Checklist <ol style="list-style-type: none"> The customer or person responsible has been given the operator's manual. The customer undertakes to read the complete operator's manual and understands all aspects of the manual before operation of the machine. All safety, operational and maintenance information have been explained and demonstrated. All greasing and oil points, stickers, guarding and ID plate have been identified and physically pointed out. The customer agrees that it is his responsibility to read and carry out the safety, maintenance and operation as per this operator's manual. 	Dealer Information <p>Dealer's Name.....</p> <p>Address.....</p> <p>State..... Postcode.....</p> <p>Phone..... Fax.....</p> <p>Email.....</p> <p>Service Person.....</p> <p>I confirm that the pre-delivery service was performed on this machine.</p> <p>Signature.....</p> <p>Date.....</p> <p>Comments.....</p>
Customer Delivery (Please Tick)	Please Complete all Customer Information Below
2. Customer Delivery Checklist <ol style="list-style-type: none"> The customer or person responsible has been given the operator's manual. The customer undertakes to read the complete operator's manual and understands all aspects of the manual before operation of the machine. All safety, operational and maintenance information have been explained and demonstrated. All greasing and oil points, stickers, guarding and ID plate have been identified and physically pointed out. The customer agrees that it is his responsibility to read and carry out the safety, maintenance and operation as per this operator's manual. 	Customer Information <p>Customer's Name.....</p> <p>Address.....</p> <p>State..... Postcode.....</p> <p>Phone..... Fax.....</p> <p>Email.....</p> <p>Delivery Person.....</p> <p>I confirm that all of the delivery checks were explained and performed.</p> <p>Signature.....</p> <p>Delivery Date.....</p> <p>Comments.....</p>



NORDLAND
EQUIPMENT
Nordland by FieldKing

WARRANTY CARD Customer Copy

CUSTOMER NAME Mr./ Mrs. :

ADDRESS :

MOBILE NO. :

Email :

NAME OF IMPLEMENT :

MODEL NO. :

YEAR OF Mfg. :

SERIAL NO. :

REGISTRATION NO. :

DATE OF PURCHASING :

NAME OF DEALER :

Customer's Signature

Dealer's Signature

EDNEY DISTRIBUTING CO., INC.

8485 215th St W, Lakeville, MN 55044

(888) 443-3639 ✉ sales@edneyco.com 🌐 www.edneyco.com



NORDLAND
EQUIPMENT
Nordland by FieldKing

WARRANTY CARD
Company Copy

CUSTOMER NAME Mr./ Mrs :

ADDRESS :

MOBILE NO. :

Email :

NAME OF IMPLEMENT :

MODEL NO. :

YEAR OF Mfg. :

SERIAL NO. :

REGISTRATION NO. :

DATE OF PURCHASING :

NAME OF DEALER :

Customer's Signature

Dealer's Signature

EDNEY DISTRIBUTING CO., INC.

8485 215th St W, Lakeville, MN 55044

(888) 443-3639 sales@edneyco.com www.edneyco.com



NORDLAND
EQUIPMENT
Nordland by FieldKing

WARRANTY CARD
Dealer Copy

CUSTOMER NAME Mr./ Mrs :

ADDRESS :

MOBILE NO. :

Email :

NAME OF IMPLEMENT :

MODEL NO. :

YEAR OF Mfg. :

SERIAL NO. :

REGISTRATION NO. :

DATE OF PURCHASING :

NAME OF DEALER :

Customer's Signature

Dealer's Signature

EDNEY DISTRIBUTING CO., INC.

8485 215th St W, Lakeville, MN 55044

(888) 443-3639 sales@edneyco.com www.edneyco.com



NORDLAND



E Q U I P M E N T

Nordland by Fieldking



EDNEY DISTRIBUTING CO., INC.

8485 215th St W, Lakeville, MN 55044

 (888) 443-3639  sales@edneyco.com  www.edneyco.com